

5000-6000MHz 1 TO 3 WAYS SPLITTER FOR N AJCK

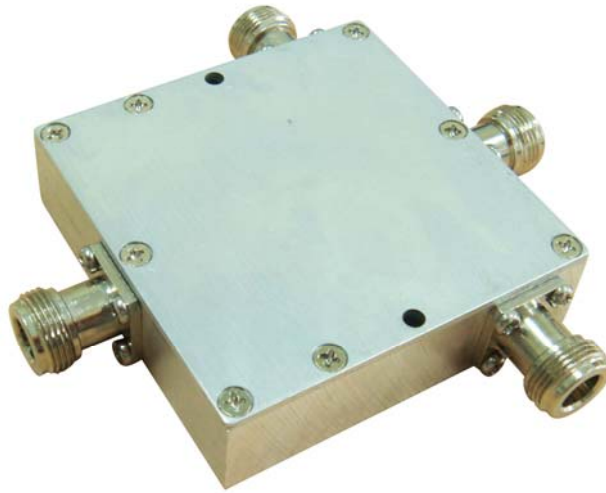

Specification		
Model No.	SP-58-02	
Description	1 TO 3 Ways Splitter	
Frequency Range (MHz)	5000 -6000	
Insertion Loss (dB)	$\leq 5.7$	
Amplitude Balance (dB)	$\leq 0.3$	
Phase Balance	$5^{\circ}$	
Standing Wave	VSWR (in)	$\leq 1.5$
	VSWR (out)	$\leq 1.5$
Isolation (dB)	$\geq 22$	
Power (W)	$\geq 30$	
Dimension (mm)	L101.5 xW101.5 xH19mm	
Port Connectors	N Female	
N.W (g)	236g	

REV	DESCRIPTION	DRAWN	DATE

5000-6000MHZ 1 TO 3 WAYS SPLITTER FOR N FEMALE

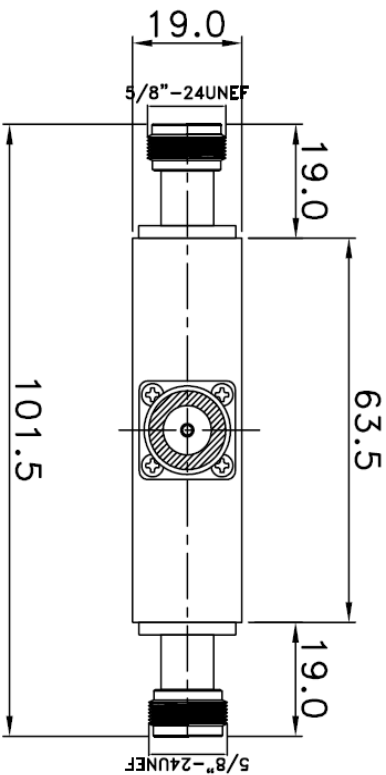
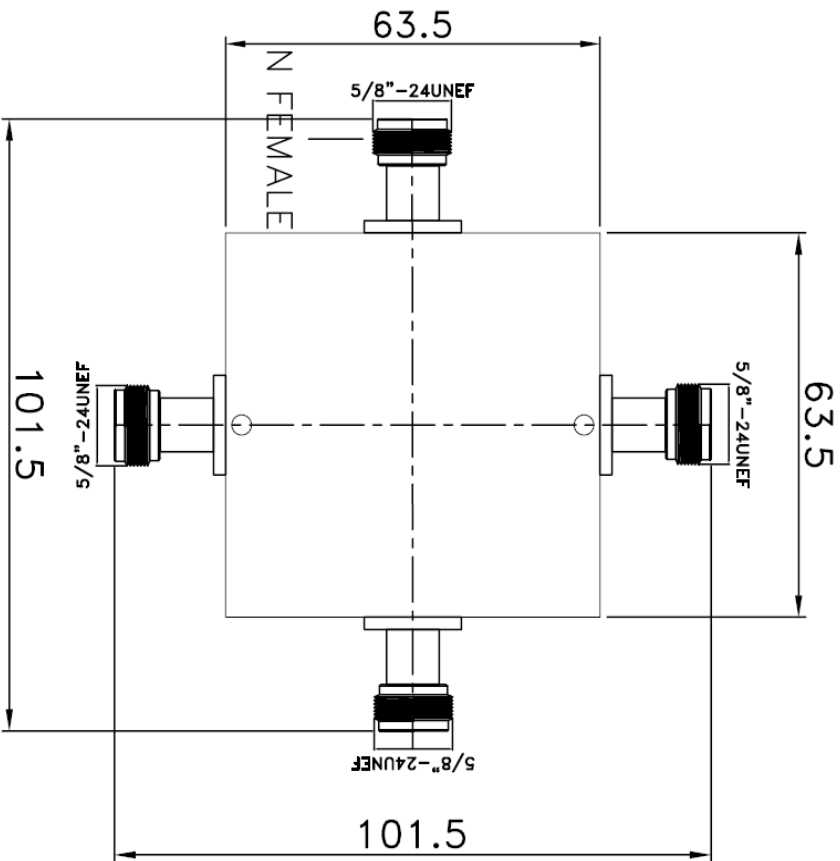

7	Power (W) : $\geq 30$
6	Port Connectors : N FEMALE
5	Isolation (dB) : $\geq 22$
4	Phase Balance : $5^\circ$
3	Amplitude Balance (dB) : $\leq 0.3$
2	Insertion Loss (dB) : $\leq 5.7$
1	Frequency Range (MHz) : 5000-6000 MHz
NO	Description

UNLESS OTHERWISE SPECIFIED		*MAJOR DIMENSION		APPROVED	
1.REMOVE ALL BURRS		UNLESS OTHERWISE		CHECKED	
2.BREAK ALL CORNERS &		NOTED TOLERANCES		DRAWN	
3.CHAMFER 1ST & LAST		0.5-6=±0.2		DRAWN DATE 03/07/04	
4.THREADS 1ST & LAST		6-30=±0.4		FILE NO.	
5.DIAMETERS ON COMMON		30-120=±0.6		DRAWING NO. SP-58-02	
CENTERS.		120-315=±1.0		TITLE	
TO BE CONCENTRIC		ANGLES=±1.0°		5000-6000MHZ 1 TO 3 WAYS SPLITTER FOR N FEMALE	
WITHIN 0.15MM				REV	
5.ALL DIMENSIONS ARE				A	
AFTER PLATING.					

S11

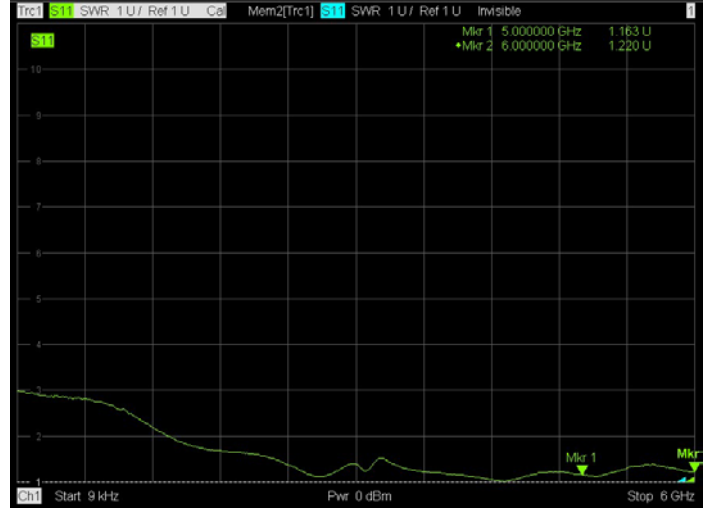

S22

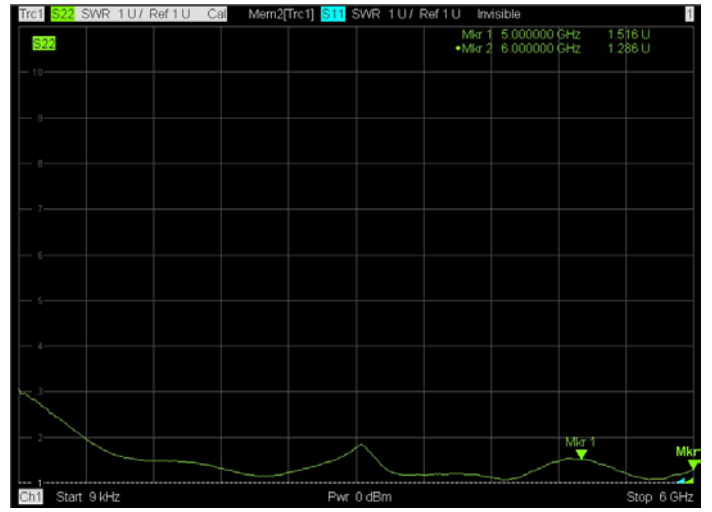
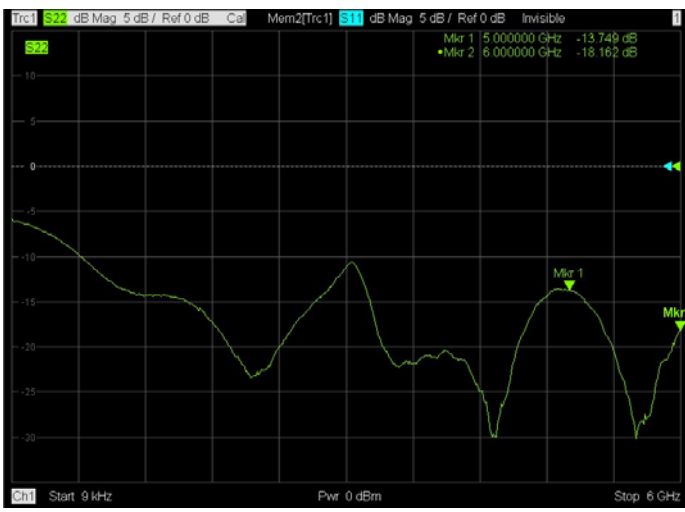

S33

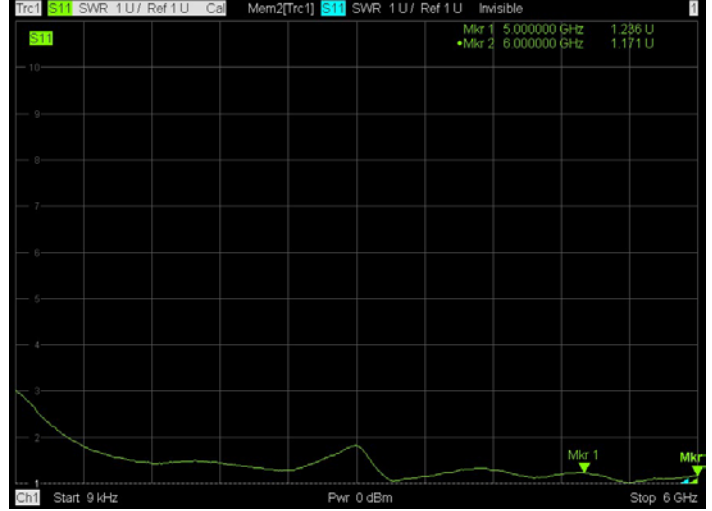
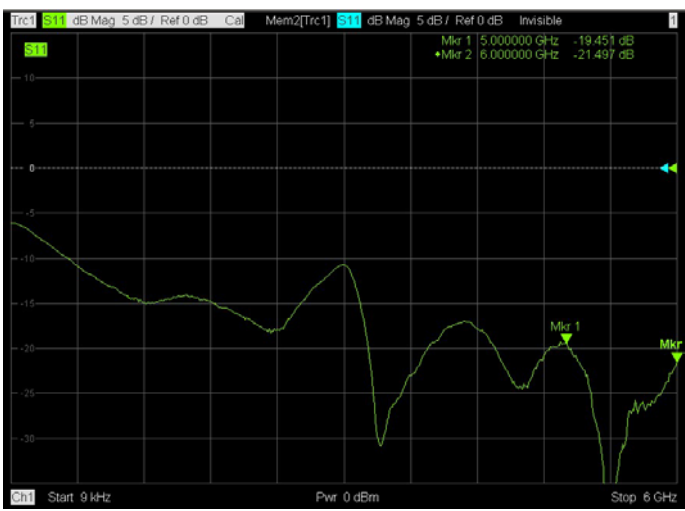

S44

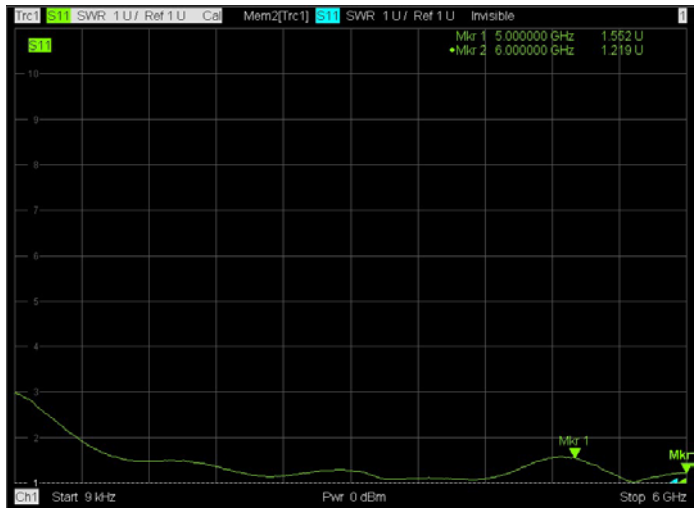
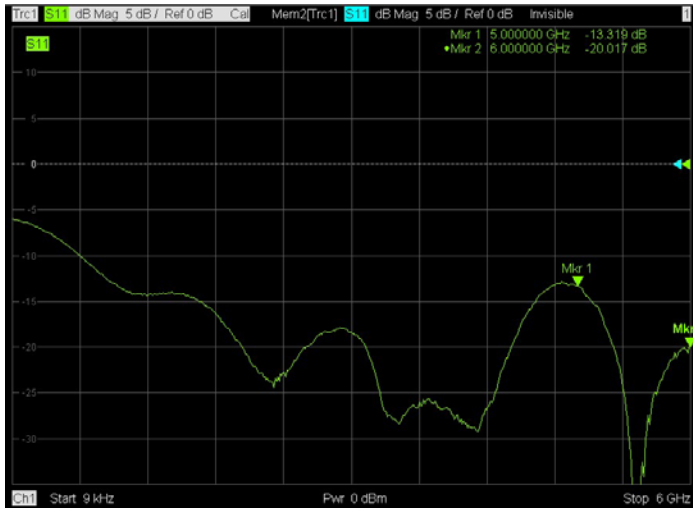

S12

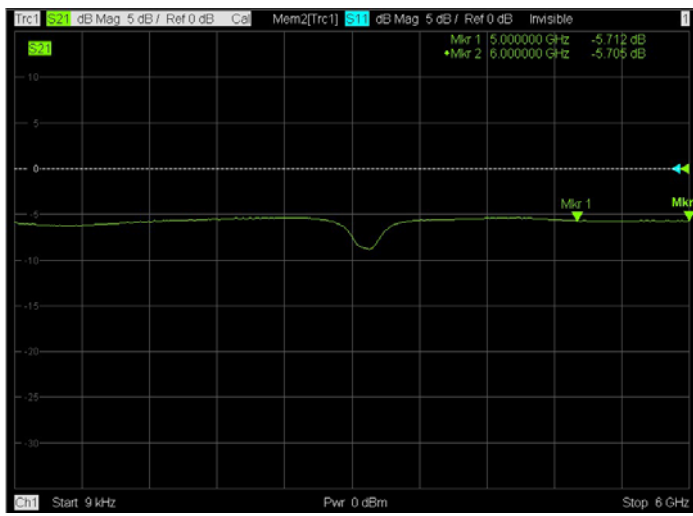

S13

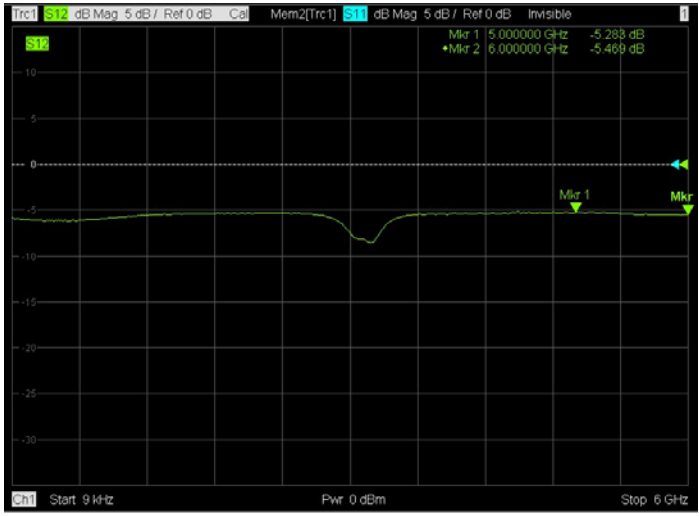

S14

